

SMD G2 Batten Installation Instructions

Model: SMD-2FT and SMD-4FT series

Please read these instructions carefully in full prior to carrying out the installation.

IMPORTANT SAFETY ISSUES

- This product must be installed by a qualified electrician according to AS/NZS 3000.
- Ensure that the AC power is disconnected at the switchboard and test to ensure that there is no power on the circuit prior to starting installation.
- This product is rated to IP20 (front) and is not suitable for damp environments.
- Modification of this product will void any warranty.
- When cleaning or replacing the light, please ensure the power is off and the light is completely cooled down. Cleaning can be done using a soft cloth and PH neutral detergent.

INSTALLATION INSTRUCTIONS

Step 1: Turn off the power supply, slide the endcaps, remove the LED diffuser part from the base.

Selecting the CCT/Wattage: Locate the LED Driver and using a screwdriver use it to slide the switch to select your required wattage (watt select versions only) and colour temperature.

Emergency models use the inline dip switch to select your colour temperature.

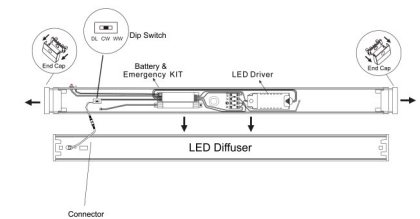
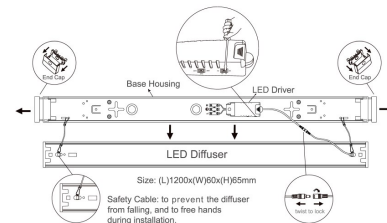

Step 2: Mount the base onto the ceiling securely.

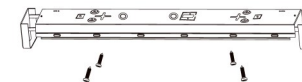

Surface Mount

Step 3: Wire the cable into the terminal block, connect the LED diffuser connector, ensuring to twist lock, assemble the diffuser back into the base and push in the end caps to lock into place.

Remember to set the power and colour temperature prior to closing up the light.

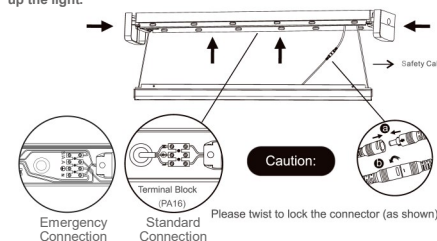

Emergency Batten: A = Hard Active (constant power)
S/A = Switched Active (allows light to be turned on and off via a wall switch, does not activate emergency light)

Warning: Battery is not connected whilst in storage. Please ensure connection of battery to the emergency controller prior to final assembly.

Step 4: Ignore this step if it is not an emergency model.

The 2FT emergency model now includes a microwave motion sensor as standard however it is not enabled.

To enable the sensor, locate the sensor at the back of the light head and connect the cable as shown. To disable the sensor, just disconnect the cable and it will operate like a normal light.

Default settings are marked below however you can easily change the settings using the dip switches on the sensor itself.



Plug in connector for sensor

Factory Defaults

Detection Area	Hold Time	Daylight Sensor	Standby DIM Level	Standby Period
100%	5s	Disabled	0%	∞
50%	60s	On	20%	15mins
	3mins			
	10mins			

Step 5: Turn back on the power, ensure the luminaire is working correctly.

Emergency Versions: Press the test button to ensure the emergency feature is working. Please allow 16hrs to fully charge the battery before completing a full emergency test.

Emergency Mode CCT

When in emergency lighting mode some versions of the emergency batten only offer 2CCT. Colour table as follows:

CCT Selection	Emergency CCT
4000K	4000K
6000K	4000K
5000K	5000K

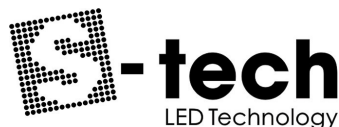

For further information contact
S-Tech Holdings Pty Ltd on 08 9330 8485