

Please read these instructions carefully in full prior to carrying out the installation.

IMPORTANT SAFETY ISSUES

- This product must be installed by a qualified electrician according to AS/NZS 3000.
- Ensure that the AC power is disconnected at the switchboard and test to ensure that there is no power on the circuit prior to starting installation.
- This product is rated to IP20 (front) and is not suitable for damp environments.
- Modification of this product will void any warranty.
- When cleaning or replacing the light, please ensure the power is off and the light is completely cooled down. Cleaning can be done using a soft cloth and PH neutral detergent.

INSTALLATION INSTRUCTIONS

Step 1: Turn off the power supply, slide the endcaps, remove the LED diffuser part from the base.

Selecting the CCT/Wattage: Locate the LED Driver and using a screwdriver use it to slide the switch to select your required wattage (watt select versions only) and colour temperature.

Emergency models use the inline dip switch to select your colour temperature.

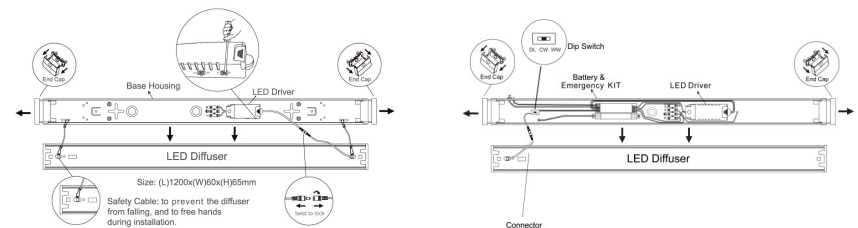

Step 2: Mount the base onto the ceiling securely.

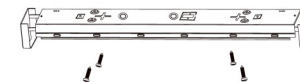

Surface Mount

Step 3: Wire the cable into the terminal block, connect the LED diffuser connector, ensuring to twist lock, assemble the diffuser back into the base and push in the end caps to lock into place.

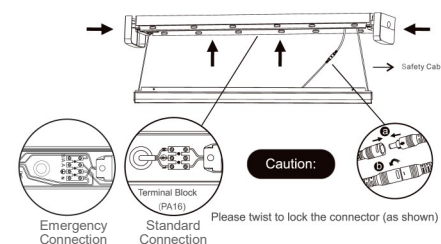

Emergency Batten: A = Hard Active (constant power)
S/A = Switched Active (allows light to be turned on and off via a wall switch, does not activate emergency light)

Step 4: Turn back on the power, ensure the luminaire is working correctly.

Emergency Versions: Press the test button to ensure the emergency feature is working. Please allow 16hrs to fully charge the battery before completing a full emergency test.

Microwave Sensor Versions: Refer to the manual provided with the remote

Note: This product is colour switching and watt select, please remember to select the correct colour and wattage prior to the final assembly of the light.